

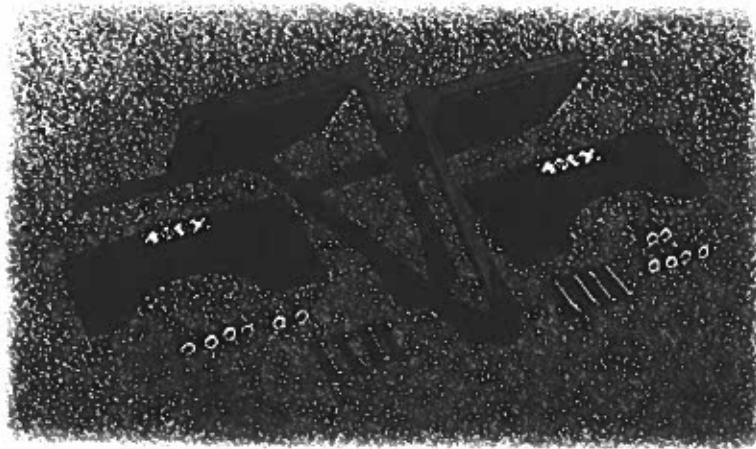

**Aero Twin, Inc. Main Gear Gravel Deflectors,
P/N GD6-100
for
Cessna Model 205 and 206**

INSTALLATION INSTRUCTIONS



LOG OF REVISIONS			
REVISIONS		PAGES REVISED AND DESCRIPTION OF REVISIONS	AERO TWIN SIGNATURE
NO.	DATE		
--	5/22/89	Original Issue	--
A	4/20/90	Revised per ECO AT-08	--
B	7/4/97	Revised per ECO AT-39, Format revised, All pages revised.	Michael Lovett
C	10/31/12	Revised pages 2-4 per ECO AT-150	Jason Kepler
D	03/11/16	Revised pages 1-2 per ECO AT-166 to add 205 Model	

Aero Twin, Inc. Main Gear Gravel Deflectors P/N GD6-100

1.0 Installation

NOTE: This kit is not to be used with installed speed fairings or other accessories mounted to the main gear.

1. Remove the left main gear wheel and axle per the FAA approved maintenance manual. Ensure that the axle alignment shims can be reinstalled in the same pattern as were originally installed.
2. Attach the left gravel deflector (GD6-101-L) as shown on drawing GD5/6-I-1, Sheet 1, using the new hardware supplied with the kit. Torque the axle attach nuts per the FAA Approved Maintenance Manual.
3. To install the tire scraper, fit it snug against the tire, on top of the installed gravel deflector, as shown on drawing GD-I-2, Sheet 1. Match drill the fastener holes through the bottom of the frame and then through the rubber tire scraper.
4. Trim the overhanging tire scraper rubber flush with the outside edge of the frame, as shown in drawing GD-I-2, Sheet 1.
5. Attach the "NO STEP" placard on the top side of the rubber tire scraper as shown on drawing GD-I-2, Sheet 1.
6. Install the right Gravel Deflector (GD6-101-R) following the same procedure, (steps 1-5).
7. Execute FAA form 337 in duplicate, stating that this gravel deflector kit was installed in accordance with this STC. The total change in airplane empty weight and balance is 8.5 lb. at fuselage station 60.5.

2.0 Parts List

Qty	Part Number	Item Description
1	GD6-209-L	Left Gravel Deflector Assembly
1	GD6-209-R	Right Gravel Deflector Assembly
2	GD-102	Rubber Tire Scraper
12	NAS1149F0632P	Washer
12	NAS1149F0532P	Washer
4	MS20002C6	Washer
4	MS20002C5	Washer
4	NAS146-47 OR MS20006-36	Bolt
4	NAS145-44 OR MS20005-35	Bolt
4	MS21042-L6	Nut
4	MS21042-L5	Nut
14	MS21042-L3	Nut
14	A3235-028-935 or FW235-28	Washer
4	MS24694-S68	Screw
10	MS24694-S64	Screw
14	NAS1149F0332P	Washer
2	GD-NSP	Placard
4	MS20470A4-9	Rivet
4	NAS1149FN432P	Washer

-----END-----

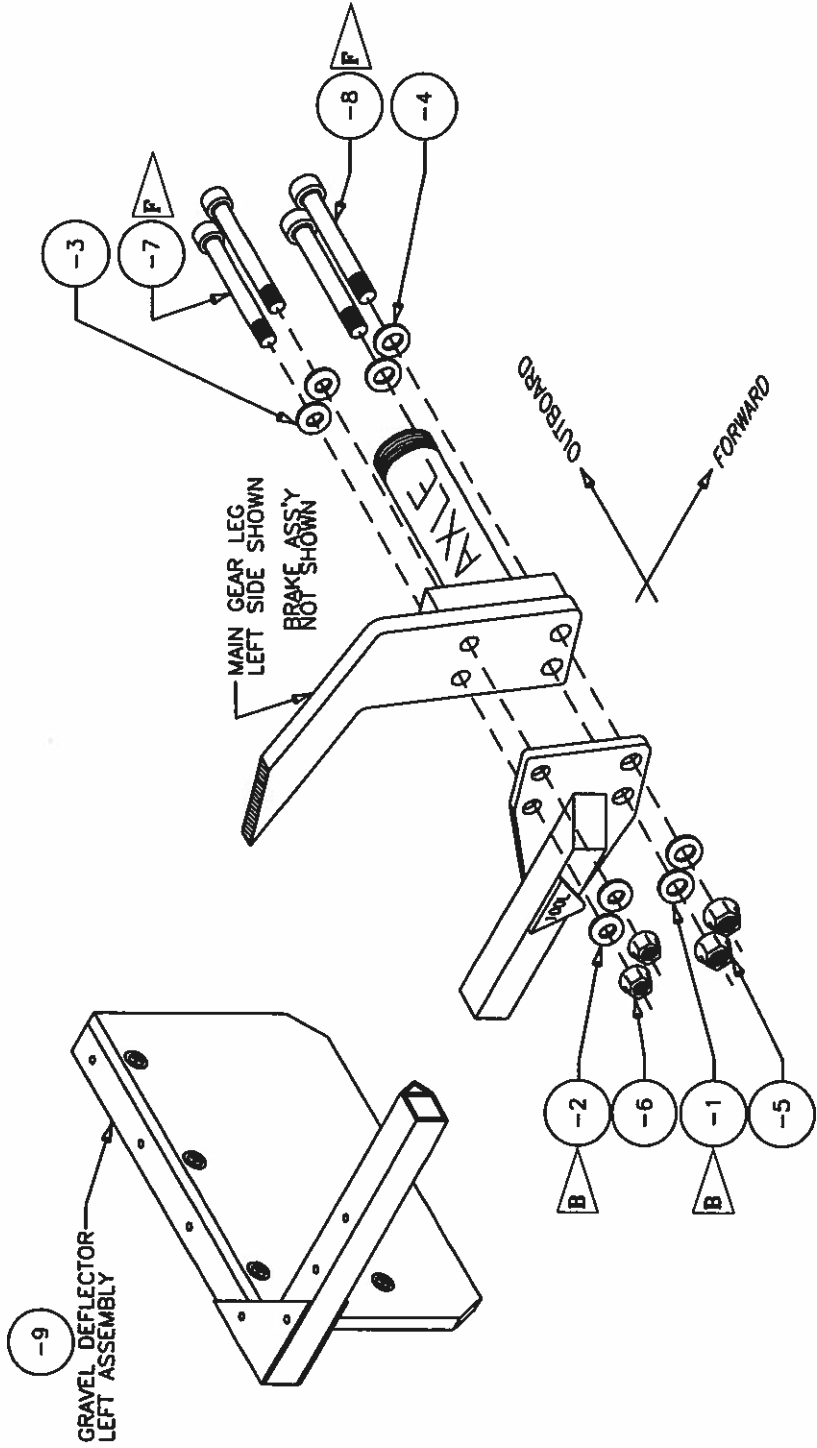

NOTE:

- 1 REMOVE WHEEL ASSEMBLY PER FAA APPROVED MAINTENANCE MANUAL.
- 2 INSTALL GRAVEL DEFLECTOR AS SHOWN; USE UP TO (3) WASHERS ON EACH BOLT AS REQUIRED FOR CORRECT THREAD EXPOSURE.
- 3 REINSTALL NUTS AND TORQUE PER FAA APPROVED MAINTENANCE MANUAL.
- 4 INSTALL WHEEL ASSEMBLY PER FAA APPROVED MAINTENANCE MANUAL.
- 5 USE P/N GD5-209-L FOR C180/185 AND P/N GD6-209-L FOR C205/206 AND C182. (RIGHT-HAND OPPOSITE).
- 6 REFER TO BOLT SCHEDULE FOR PROPER BOLT APPLICATION.

BOLT SCHEDULE

ITEM	QTY	PART NO.	DESCRIPTION	A/C APPLICATION
-7	4	MS145-40 OR MS20005-31	BOLT	CESSNA 180/185 MODELS
-7	4	MS145-44 OR MS20005-35	BOLT	182 (S/N 33000-51888) & 205/206
-7	4	MS145-45 OR MS20005-36	BOLT	182 (S/N 51889-53988), 182C, 182F, & 182G
-7	4	MS145-41 OR MS20005-32	BOLT	182M, 182L, 182K, 182L, 182M, & 182N
-7	4	MS145-35 OR MS20005-28	BOLT	182P, 182Q, 182R, & T182
-8	4	MS145-45 OR MS20006-34	BOLT	180, 180A, 180B, 180C, 180D, 180E, 182E, 182F, & 182G
-8	4	MS145-41 OR MS20006-30	BOLT	180F, & NEWER MODELS AND 185
-8	4	MS145-47 OR MS20006-38	BOLT	182 (S/N 51887-53988) & 205/206
-8	4	MS145-43 OR MS20006-32	BOLT	182 (S/N 33000-51888), 182H, 182J, 182K, 182L, 182M, & 182N
-8	4	MS145-35 OR MS20006-24	BOLT	182P, 182Q, 182R, & T182
ITEM	QTY	PART NO.	DESCRIPTION	A/C APPLICATION

* QUANTITY AS REQUIRED; TWELVE (12) EACH SUPPLIED WITH KIT.

ITEM	QTY	PART NO.	DESCRIPTION	MATERIAL	DIMENSION	SPECIFICATION
-1	4	MS11497063P	WASHER			
-2	4	MS11497065P	WASHER			
-3	4	MS20002C3	WASHER			
-4	4	MS20002C8	WASHER			
-5	4	MS21042L6	NUT			
-6	4	MS21042L5	NUT			
-7	4	SEE BOLT SCHEDULE	BOLT			
-8	4	SEE BOLT SCHEDULE	BOLT			
-9	12	TRILL	GRAVEL DEFLECTOR WELDMENT			

D	ECO AT-166	03/11/16	JMK
C	ECO AT-150	10/31/12	CBW
B	ECO AT-128	07/15/08	BAS
A	REVISED PER ECO AT-68	06/14/01	MAH
LET	ORIGINATED PER ECO AT-39	07-04-97	DRG
	REVISION	DATE	INIT

AERO TWIN, INC.
 2403 MERRILL FIELD DRIVE ANCHORAGE AK 99501
 CESSNA 180/182/185/205/206

GRAVEL DEFLECTOR INSTALLATION

X.X =	X.XX =	X.XXX =	X.X" =
± 0.1	± 0.05	± 0.01	± 3"

DWN: DRG DATE: 6-27-97 SCALE: NTS
 APP'D: M. LOVETT DWG: GD5/6-I-1
 SHEET: 1 OF 1

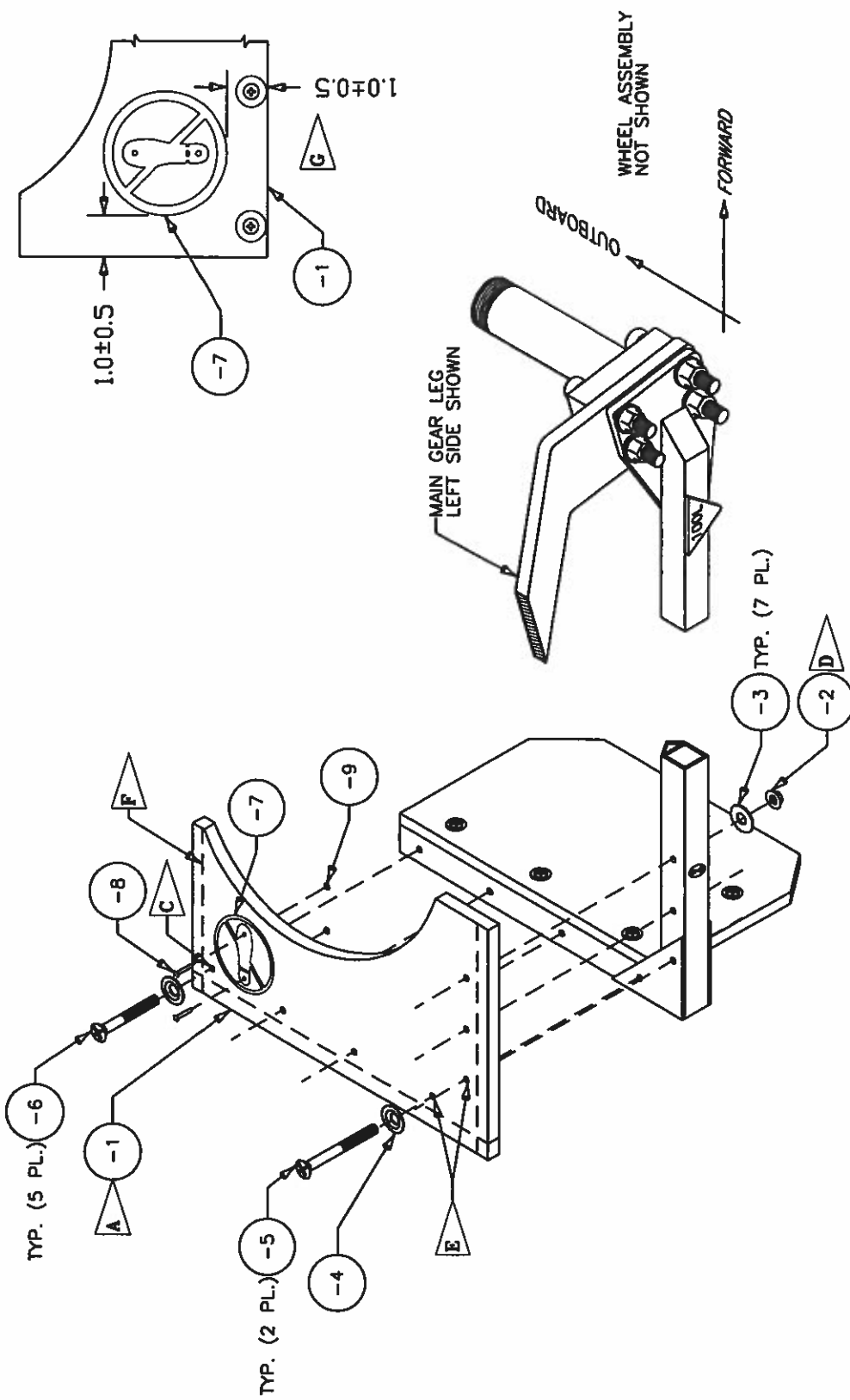

NOTE:

- ▲ GD-102 IS SUPPLIED UNDRILLED AND OVERSIZED. INSTALL SCRAPER ONLY AFTER DEFLECTOR FRAME IS INSTALLED ON AIRCRAFT AND WHEEL/TIRE ASSEMBLY IN PLACE ON AXLE.
- ▲ FIT SCRAPER ON TOP SURFACE OF FRAME. SNUG AGAINST TIRE. MATCH DRILL 3/16 HOLES THROUGH SCRAPER AT (7) PLACES. BORE OUT HOLES THROUGH SCRAPER USING 1/4 DRILL.
- ▲ INSTALL SCRAPER USING LISTED HARDWARE. TIGHTEN ITEM -2 UNTIL OUTSIDE EDGE OF ITEM -4 CONTACTS SURFACE OF ITEM -1. MAINTAIN MINIMUM OF 1.5-THREAD EXPOSURE THROUGH LOCKING FEATURE OF ITEM -2.
- ▲ (2) MS24694S68 ARE INSTALLED IN THE CORNER THROUGH THE GUSSET PLATE.
- ▲ TRIM EXCESS MATERIAL FROM SCRAPER, FLUSH WITH OUTSIDE EDGE OF FRAME.
- ▲ AFTER TRIMMING SCRAPER, POSITION ITEM -7 AS SHOWN AND MATCH DRILL SCRAPER TO ACCEPT ITEM -8 RIVETS. ATTACH ITEM -7 TO TOP OF SCRAPER USING ITEMS -8 AND -9. OPTIONALLY, ITEMS -7, -8 AND -9 MAY BE OMITTED AND REPLACED WITH A SELF-ADHESIVE "NO STEP" PLACARD (AVAILABLE FROM WWW.AIRCRAFTSPRUCE.COM AS P/N 09-34500) AFFIXED TO THE TOP SURFACE OF THE SCRAPER, CENTERED AT THE REAR EDGE.

ITEM	QTY	PART NO.	DESCRIPTION	MATERIAL	DIMENSION	SPECIFICATION
-1	2	GD-102	TIRE SCRAPER			GD-P. 3 OF 3
-2	14	MS21042L3	NUT			
-3	14	MS1148F432P	WASHER			
-4	14	A3235-02B-035	WASHER			AL P/N PW235-26
-5	4	MS24694S68	SCREW			
-6	10	MS24694S64	SCREW			
-7	2	GD-MS2P	PLACARD			GD-MS2P. 1 OF 1
-8	4	MS20470A4-8	RIVET			
-9	4	MS1148F432P	WASHER			

D	ECO AT-166	03/11/16	JMK
C	ECO AT-150	10/31/12	CBW
B	ECO AT-128	07/15/08	BAS
A	REVISED PER ECO AT-69	06/14/01	MAH
	ORIG ISSUED PER ECO AT-39	07-04-97	DRG
LET	REVISION	DATE	INIT

AERO TWIN, INC.
 2403 MERRILL FIELD DRIVE ANCHORAGE AK 99501
 CESSNA 180/182/185/205/206/207

TIRE SCRAPER INSTALLATION				
MANUFACTURING PROCESS CONTROL				
X.X	=	X.XXX	=	X.X" =
± 0.1	±	0.05	±	0.01
± 0.1	±	0.05	±	0.01
± 0.1	±	0.05	±	0.01
DWG: DRG DATE: 6-27-97 SCALE: NTS				
APP'D: M. LOWETT DWG: GD-I-2				
SHEET: 1 OF 1				